

COROMAL



PIONEER EVOLUTION XC



COROMALWINDSOR.COM.AU

**Note: Please be advised this is a preliminary document, and all models and specifications are subject to change without notice.*

Doc# PEXR02



PIONEER EVOLUTION XC

PEX552S



Body Length (mm)	5,500
Overall Length (mm)	7,655
Overall Height – Standard (mm)	3,090
Interior Height (mm)	1,980
Overall Body Width (mm)	2,470
Tare Weight (kg)	2,215*
ATM Weight (kg)	2,665*

PEX553S

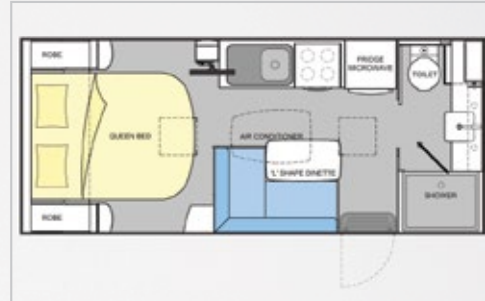

Body Length (mm)	5,500
Overall Length (mm)	7,655
Overall Height – Standard (mm)	3,090
Interior Height (mm)	1,980
Overall Body Width (mm)	2,470
Tare Weight (kg)	2,200*
ATM Weight (kg)	2,650*

PEX612S

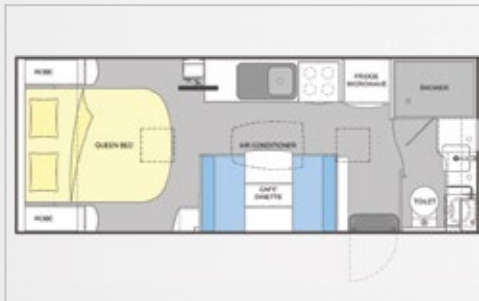

Body Length (mm)	6,150
Overall Length (mm)	8,305
Overall Height – Standard (mm)	3,090
Interior Height (mm)	1,980
Overall Body Width (mm)	2,470
Tare Weight (kg)	2,550*
ATM Weight (kg)	3,300*

PEX632S



Body Length (mm)	6,300
Overall Length (mm)	8,454
Overall Height – Standard (mm)	3,090
Interior Height (mm)	1,980
Overall Body Width (mm)	2,470
Tare Weight (kg)	2,645*
ATM Weight (kg)	3,395*

*Note: Weights and specifications shown are indicative and are meant as a guide only. Weights may vary between builds and will change when adding options. Due to progressive product improvements all specifications are subject to change without notice. Images are not to scale and are only for illustration purposes.



PIONEER EVOLUTION XC

PEX636S



Body Length (mm)	6,300
Overall Length (mm)	8,454
Overall Height – Standard (mm)	3,090
Interior Height (mm)	1,980
Overall Body Width (mm)	2,470
Tare Weight (kg)	2,650*
ATM Weight (kg)	3,400*

PEX661S



Body Length (mm)	6,600
Overall Length (mm)	8,755
Overall Height – Standard (mm)	3,090
Interior Height (mm)	1,980
Overall Body Width (mm)	2,470
Tare Weight (kg)	2,850*
ATM Weight (kg)	3,500*

PEX662S



Body Length (mm)	6,600
Overall Length (mm)	8,755
Overall Height – Standard (mm)	3,090
Interior Height (mm)	1,980
Overall Body Width (mm)	2,470
Tare Weight (kg)	2,740*
ATM Weight (kg)	3,390*

PEX696S



Body Length (mm)	6,900
Overall Length (mm)	9,055
Overall Height – Standard (mm)	3,090
Interior Height (mm)	1,980
Overall Body Width (mm)	2,470
Tare Weight (kg)	2,840*
ATM Weight (kg)	3,490*

*Note: Weights and specifications shown are indicative and are meant as a guide only. Weights may vary between builds and will change when adding options. Due to progressive product improvements all specifications are subject to change without notice. Images are not to scale and are only for illustration purposes.



COROMAL

PIONEER EVOLUTION XC SPECIFICATIONS

CHASSIS

2018 Modular Assembled Evolution Chassis
Coupling swivel "PIN"
Easy-Tow Sport X Rally Wishbone Heavy Duty Suspension
Modular Assembled A-frame and Outriggers
16" Tyres with steel wheels
8" Jockey wheel and quick release jack legs
Step - recessed and slide-out step
Water tank guards

APPLIANCES

Air conditioner
Stove with grill (1 electric / 3 gas burners)
190L AES 3-Way Fridge (12V / 240V / Gas)
Instantaneous Hot Water System (Gas)
Microwave 25L
12V recessed rangehood with twin lights
22" TV on arm
Radio / CD / DVD / USB / Bluetooth Colour touch screen
Internal speakers x2, External speakers x2
Antenna - Digital Winegard Sensor
Prewired reversing camera provision

POWER & ELECTRICS

External 240V power outlet, USB 12V / CIG socket
External TV antenna inlet
External TV coaxial outlet
2x 150W Solar panel with 1x 30amp reg
2x 12V Battery
Transformer - 12V power supply / battery charger 25amp
12V mains light over-ride switch
Power Point (USB Point & 12V) - dinette, bedroom
Annex lights x2
Light strip to kitchen overhead cupboard
LED downlights to ensuite overhead cupboard
Reading lights to bedroom x2 and Dinette x2
Pelmet Light

GAS

Gas bottles 9kg x2
Double regulator
External gas bayonet

SAFETY

Electronic stability control braking system
Breakaway brakes
Entry light and grab handle
Non-slip ABS recessed entry step

CONSTRUCTION

Future Teck™ walls (one-piece)
Future Teck™ aluminium construction
Large Rear Air Foil Spoiler
ABS Rear Panels
A-frame tool box XC (Gas, storage and jerry can provision)
Front tunnel boot with boot light
Front high stone guard
Glass Hopper windows
Flyscreen and blackout blinds
Roll-out awning
Roof hatch x2
Pressurising hatch
Outdoor surface mounted picnic table

KITCHEN & PLUMBING

Kitchen sink - stainless steel bowl and drainer
Kitchen tap - swivel mixer
Kitchen splashback full height
Water gauge and lockable water filler to each tank
Mains water inlet to mains water tap
12V water pump with isolation taps
Moulded cutlery tray
Laminated Future Teck™ benchtops
Flush gloss kitchen cabinets with soft close drawers
External shower

BEDROOM

Upholstered head board
Memory foam mattresses
Bed frame (Queen) - slatted with 100mm extension
Lift up bed - storage access
Bed drawer/s

MODEL SPECIFIC STANDARDS

Future Teck™ Ensuite Sliding Door	PEX552S PEX553S PEX632S PEX661S PEX662S PEX696S
Spare steel wheel x1	PEX552S PEX553S
Spare steel wheel x2	PEX612S PEX632S PEX636S PEX661S PEX662S PEX696S
Side tool box x1	PEX552S PEX661S
Side tool box x2	PEX553S PEX612S PEX632S PEX636S PEX662S PEX696S
USB sockets and reading lights to bunks	PEX636S PEX696S
Washing machine top load 2.5kg	PEX612S PEX632S PEX661S PEX662S
Washing machine front load 4kg	PEX696S
Water tank 2x 60L	PEX552S PEX553S
Water tank 2x 80L	PEX612S PEX632S PEX636S PEX661S PEX662S PEX696S
Grey water tanks 2x 43L	PEX552S PEX553S
Grey water tanks 1x 110L	PEX612S PEX632S PEX636S PEX661S PEX662S PEX696S

*Note: Appliances may vary depending on availability. Not all items may be listed in this publication. Specifications are subject to change due to progress product improvements.