

# SILHOUETTE Windsor



[COROMALWINDSOR.COM.AU](http://COROMALWINDSOR.COM.AU)

# SILHOUETTE Windsor



## S400XC

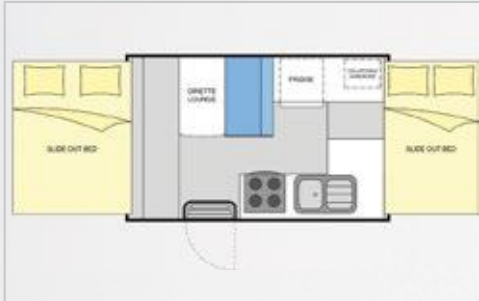

Body Length (mm)	3,400
Overall Length (mm)	5,430
Overall Height – Roof Up (mm)	3,052
Overall Height – Roof Down (mm)	2,095
Overall Body Width (mm)	2,210
Tare Weight (kg)	1,680*
ATM Weight (kg)	2,080*

## S401XC



Body Length (mm)	3,400
Overall Length (mm)	5,430
Overall Height – Roof Up (mm)	3,052
Overall Height – Roof Down (mm)	2,095
Overall Body Width (mm)	2,210
Tare Weight (kg)	1,770*
ATM Weight (kg)	2,170*

## S421XC

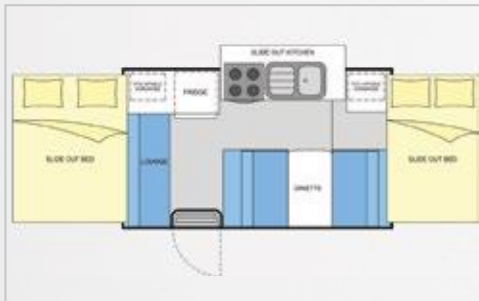

Body Length (mm)	3,600
Overall Length (mm)	5,630
Overall Height – Roof Up (mm)	3,052
Overall Height – Roof Down (mm)	2,095
Overall Body Width (mm)	2,210
Tare Weight (kg)	1,780*
ATM Weight (kg)	2,180*

## S450XC



Body Length (mm)	3,900
Overall Length (mm)	5,920
Overall Height – Roof Up (mm)	3,052
Overall Height – Roof Down (mm)	2,095
Overall Body Width (mm)	2,210
Tare Weight (kg)	1,830*
ATM Weight (kg)	2,230*

\*Note: Weights and specifications shown are indicative and are meant as a guide only. Weights may vary between builds and will change when adding options. Due to progressive product improvements all specifications are subject to change without notice. Images are not to scale and are only for illustration purposes.

# SILHOUETTE Windsor



## S400X4

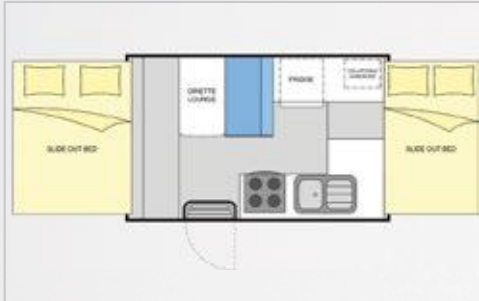

Body Length (mm)	3,400
Overall Length (mm)	5,430
Overall Height – Roof Up (mm)	3,176
Overall Height – Roof Down (mm)	2,220
Overall Body Width (mm)	2,210
Tare Weight (kg)	1,780*
ATM Weight (kg)	2,180*

## S401X4



Body Length (mm)	3,400
Overall Length (mm)	5,430
Overall Height – Roof Up (mm)	3,176
Overall Height – Roof Down (mm)	2,220
Overall Body Width (mm)	2,210
Tare Weight (kg)	1,860*
ATM Weight (kg)	2,260*

## S421X4



Body Length (mm)	3,600
Overall Length (mm)	5,630
Overall Height – Roof Up (mm)	3,176
Overall Height – Roof Down (mm)	2,220
Overall Body Width (mm)	2,210
Tare Weight (kg)	1,870*
ATM Weight (kg)	2,270*

## S450X4



Body Length (mm)	3,900
Overall Length (mm)	5,920
Overall Height – Roof Up (mm)	3,176
Overall Height – Roof Down (mm)	2,220
Overall Body Width (mm)	2,210
Tare Weight (kg)	1,930*
ATM Weight (kg)	2,330*

\*Note: Weights and specifications shown are indicative and are meant as a guide only. Weights may vary between builds and will change when adding options. Due to progressive product improvements all specifications are subject to change without notice. Images are not to scale and are only for illustration purposes.



## SILHOUETTE SPECIFICATIONS

### CHASSIS

Modular Galvanized Steel  
Coupling swivel  
16" Tyres with steel wheels  
Spare wheel mount on rear  
8" Jockey wheel with quick release jack legs  
Step - recessed  
Slide-out step  
Water tank guard

### APPLIANCES

Stove with grill (1 electric / 3 gas burners)  
90L AES 3-Way Fridge (12V / 240V / Gas)  
Microwave 25L  
Radio / CD / DVD / USB / Bluetooth Colour touch screen  
Internal speakers x2, External speakers x2  
Prewired reversing camera provision

### POWER & ELECTRICS

External 240V power outlet, USB 12V / CIG socket  
External TV antenna inlet  
External TV coaxial outlet  
Transformer - 12V power supply / battery charger 25amp  
12V mains light over-ride switch  
12V CIG / USB socket - dinette  
USB socket - TV area  
Annex light  
LED ceiling rope lights  
Reading lights with fans to bedroom x2

### GAS

Gas bottles 9kg x2  
Double regulator

### SAFETY

Off road bush electronic brakes  
Non-slip ABS recessed entry step

### CONSTRUCTION

Future Teck™ walls and roof  
Lift Teck™ | Patented cable-free safe lifting mechanism  
Front storage compartment (Gas, general storage)  
Lower tunnel locker and tunnel boot  
Side toolbox  
Front stone deflector  
Heavy grade PVC windows  
Box awning

### KITCHEN & PLUMBING

Kitchen sink - stainless steel bowl and drainer  
Kitchen tap - low profile swivel mixer  
Water gauge  
43L water tank x3, 43L grey water tanks x2  
Lockable water filler  
Mains water tap to A-frame  
Mains water inlet  
12V water pump  
Moulded cutlery tray  
Laminated plywood benchtops  
Flush gloss kitchen cabinets with soft close drawers

### BEDROOM

Memory foam mattress

### OTHER

External shower  
Ceiling hatch

## MODEL SPECIFIC STANDARDS

### S400XC | S401XC | S421XC | S450XC

Esy-Tow Sport X Independent Suspension  
Rear spare wheel and jerry can provision  
1x 150W Solar Panel with 1x 30amp reg, 1 battery

### S400X4 | S401X4 | S421X4 | S450X4

Esy-Tow Trailing Arm Independent Suspension  
Rear spare wheel, jerry can provision and locker  
2x 150W Solar Panel with 1x 30amp reg, 2 batteries  
Airconditioner  
External kitchen  
Hot Water System (Gas / 240V)  
19" TV no swing arm  
Scrub bars to roof

*\*Note: Appliances may vary depending on availability. Not all items may be listed in this publication. Specifications are subject to change due to progress product improvements.*