

COROMAL

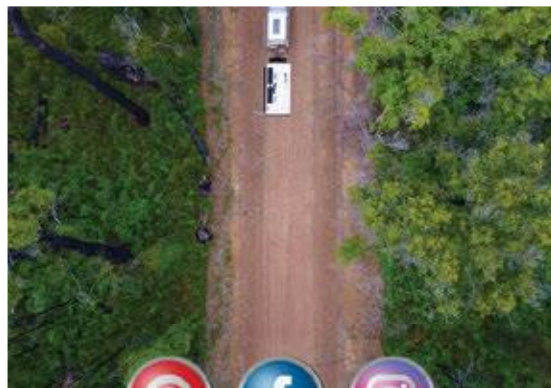

PIONEER XC



COROMALWINDSOR.COM.AU

PIONEER XC

PXC552S



Body Length (mm)	5,500
Overall Length (mm)	7,565
Overall Height – Standard (mm)	3,050
Interior Height (mm)	1,980
Overall Body Width (mm)	2,480
Tare Weight (kg)	2,350*
ATM Weight (kg)	2,750*

PXC553S

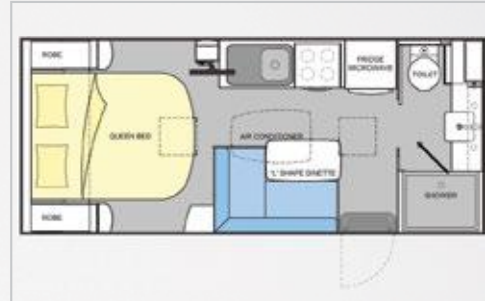

Body Length (mm)	5,500
Overall Length (mm)	7,565
Overall Height – Standard (mm)	3,050
Interior Height (mm)	1,980
Overall Body Width (mm)	2,480
Tare Weight (kg)	2,290*
ATM Weight (kg)	2,690*

PXC612S



Body Length (mm)	6,150
Overall Length (mm)	8,250
Overall Height – Standard (mm)	3,050
Interior Height (mm)	1,980
Overall Body Width (mm)	2,480
Tare Weight (kg)	2,790*
ATM Weight (kg)	3,390*

PXC632S



Body Length (mm)	6,300
Overall Length (mm)	8,425
Overall Height – Standard (mm)	3,050
Interior Height (mm)	1,980
Overall Body Width (mm)	2,480
Tare Weight (kg)	2,770*
ATM Weight (kg)	3,370*

*Note: Weights and specifications shown are indicative and are meant as a guide only. Weights may vary between builds and will change when adding options. Due to progressive product improvements all specifications are subject to change without notice. Images are not to scale and are only for illustration purposes.

PIONEER XC

PXC636S



Body Length (mm)	6,300
Overall Length (mm)	8,425
Overall Height – Standard (mm)	3,050
Interior Height (mm)	1,980
Overall Body Width (mm)	2,480
Tare Weight (kg)	2,780*
ATM Weight (kg)	3,380*

PXC661S



Body Length (mm)	6,600
Overall Length (mm)	8,760
Overall Height – Standard (mm)	3,050
Interior Height (mm)	1,980
Overall Body Width (mm)	2,480
Tare Weight (kg)	2,960*
ATM Weight (kg)	3,460*

PXC662S



Body Length (mm)	6,600
Overall Length (mm)	8,760
Overall Height – Standard (mm)	3,050
Interior Height (mm)	1,980
Overall Body Width (mm)	2,480
Tare Weight (kg)	2,860*
ATM Weight (kg)	3,360*

PXC696S



Body Length (mm)	6,900
Overall Length (mm)	9,010
Overall Height – Standard (mm)	3,050
Interior Height (mm)	1,980
Overall Body Width (mm)	2,480
Tare Weight (kg)	2,950*
ATM Weight (kg)	3,450*

*Note: Weights and specifications shown are indicative and are meant as a guide only. Weights may vary between builds and will change when adding options. Due to progressive product improvements all specifications are subject to change without notice. Images are not to scale and are only for illustration purposes.



COROMAL

PIONEER XC SPECIFICATIONS

CHASSIS

Modular Galvanized Steel
Coupling swivel
Ezy-Tow Trailing Arm Independent Suspension
16" Tyres with steel wheels
8" Jockey wheel with quick release jack legs
Bottle jack kit
A-frame tool box XC (Gas, storage and jerry can provision)
Step - recessed and slide-out step
Water tank guard

APPLIANCES

Air conditioner
Stove with grill (1 electric / 3 gas burners)
190L AES 3-Way Fridge (12V / 240V / Gas)
Hot Water System (Gas / 240V)
Microwave 25L
12V Rangehood with twin lights
22" TV on arm
Radio / CD / DVD / USB / Bluetooth Colour touch screen
Internal speakers x2, External speakers x2
Antenna - Digital Winegard Sensar
Prewired reversing camera provision

POWER & ELECTRICS

External 240V power outlet, USB 12V / CIG socket
External TV antenna inlet
External TV coaxial outlet
2x 150W Solar panel with 1x 30amp reg
2x 12V Battery and provision
Transformer - 12V power supply / battery charger 25amp
12V mains light over-ride switch
Power Point (USB Point & 12V Cigarette) - dinette, bedroom
Annex lights x2
Light strip to kitchen overhead cupboards
Reading lights to bedroom x2 and Dinette x2
Pelmet Lights

GAS

Gas bottles 9kg x2
Double regulator

SAFETY

Electronic stability control braking system with breakaway brakes
Entry light and grab handle
Non-slip ABS recessed entry step

CONSTRUCTION

Future Teck™ Rear wall
Front tunnel boot with boot light
Front high stone guard
Push out Viento windows
Flyscreen and blackout blinds
Roll-out awning
Roof hatch x2
Pressurising hatch
Outdoor Picnic table

KITCHEN & PLUMBING

Kitchen sink - stainless steel bowl and drainer
Kitchen tap - swivel mixer
Kitchen splashback full height
Water gauge and lockable water filler to each tank
Mains water tap to A-frame and mains water inlet
12V water pump with isolation taps
Moulded cutlery tray
Laminated plywood benchtops
Flush gloss kitchen cabinets with soft close drawers
External shower

BEDROOM

Upholstered head board
Memory foam mattresses
Bed frame (Queen) - slatted with 100mm extension
Lift up bed - storage access
Bed drawer/s

MODEL SPECIFIC STANDARDS

Spare steel wheel x1	PXC552S PXC553S
Spare steel wheel x2	PXC612S PXC632S PXC636S PXC661S PXC662S PXC696S
Spare wheel mount on rear bumper	PXC552S PXC553S PXC632S PXC636S PXC661S PXC662S PXC696S
Spare wheel mount on A-frame	PXC612S
Aluminium cap bumper	PXC632S PXC636S PXC661S PXC662S PXC696S
Aluminium cap bumper with jerry can provision	PXC552S PXC553S PXC612S
Side tool box x1	PXC552S PXC661S
Side tool box x2	PXC553S PXC612S PXC632S PXC636S PXC662S PXC696S
USB sockets and reading lights to bunks	PXC636S PXC696S
Washing machine top load 2.5kg	PXC612S PXC632S PXC661S PXC662S
Washing machine front load 4kg	PXC696S
Water tank 2x 60L	PXC552S PXC553S
Water tank 2x 80L	PXC612S PXC632S PXC636S PXC661S PXC662S PXC696S
Grey water tanks 2x 43L	PXC552S PXC553S
Grey water tanks 3x 43L	PXC612S PXC632S PXC636S PXC661S PXC662S PXC696S

**Note: Appliances may vary depending on availability. Not all items may be listed in this publication.
Specifications are subject to change due to progress product improvements.*