

Windsor

SILHOUETTE

S400 XC/X4 | S401 XC/X4 | S421 XC/X4 | S450 XC/X4

The Windsor Silhouette is a range of camper built for adventure. From iconic stock routes to stunning national parks and everything in between, the Windsor Silhouette gives you the freedom to explore.

Built in WA with our Future Teck™ construction, the low tow height of this camper is great for storage at home and provides greater fuel efficiency when on the move. Our Lift Teck™ mechanism offers cable-free technology moving away from traditional, unreliable lifting systems. It provides a reliable way to set-up and pack away your camper efficiently.

With options of our Esy-Tow™ Sport X or Trailing Arm suspension systems, the journey becomes an easy and predictable one, reducing bounce and eliminating sideways suspension movement.

Built on a modular, galvanized steel chassis, the Silhouette comes with a swivel coupling, 16 inch steel wheels and quick-release jack legs. The A-frame holds a large toolbox for maximum storage efficiency and an outside mains

water tap, useful to wash down dirt from the day's adventure.

Included on all models is a kitchen with a built-in 90L 3-way fridge, microwave, stove with grill and stainless steel sink. With efficient storage facilities, the Silhouette provides ample bench space with lower cupboards, allowing you to keep all your belongings in a safe and convenient area.

Silhouette models include memory foam mattresses, privacy curtains and collapsible wardrobes giving ample storage when in use. The canvas windows include built-in fly screens and curtains allowing maximum airflow and keeping out the bugs. Other features include an awning, annex light, external power outlet, TV point and a built-in sound system with radio, CD, DVD and USB connectivity. The external hand-held shower also comes as a standard across all models. ■







SILHOUETTE FLOOR PLANS

Silhouette S400XC

Body Length (mm)	3,400
Overall Length (mm)	5,430
Overall Height – Roof Up (mm)	3,052
Overall Height – Roof Down (mm)	2,095
Overall Body Width (mm)	2,210
Tare Weight (kg)	1,680*
ATM Weight (kg)	2,080*

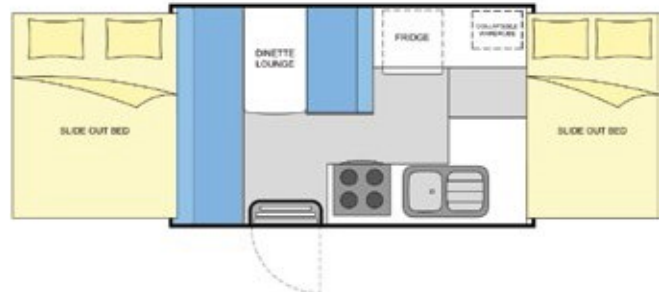

Silhouette S401XC

Body Length (mm)	3,400
Overall Length (mm)	5,430
Overall Height – Roof Up (mm)	3,052
Overall Height – Roof Down (mm)	2,095
Overall Body Width (mm)	2,210
Tare Weight (kg)	1,770*
ATM Weight (kg)	2,170*

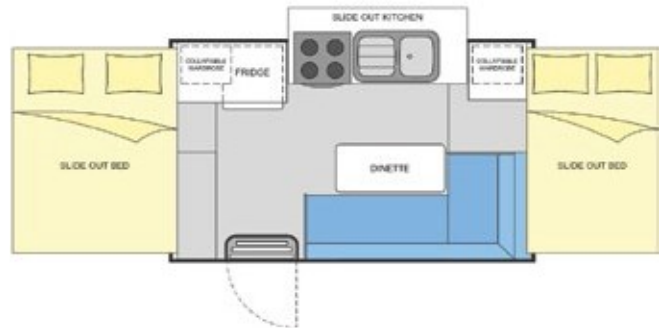

Silhouette S421XC

Body Length (mm)	3,600
Overall Length (mm)	5,630
Overall Height – Roof Up (mm)	3,052
Overall Height – Roof Down (mm)	2,095
Overall Body Width (mm)	2,210
Tare Weight (kg)	1,780*
ATM Weight (kg)	2,180*

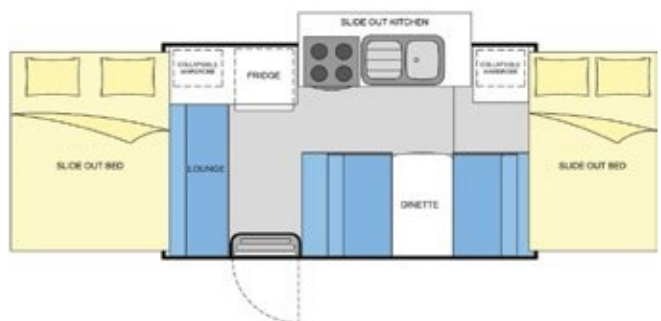

Silhouette S450XC

Body Length (mm)	3,900
Overall Length (mm)	5,920
Overall Height – Roof Up (mm)	3,052
Overall Height – Roof Down (mm)	2,095
Overall Body Width (mm)	2,210
Tare Weight (kg)	1,830*
ATM Weight (kg)	2,230*



*Note: Tare and ATM weights will vary when adding optional extras. Images are not to scale and are only for illustration purposes.



Silhouette S400X4

Body Length (mm)	3,400
Overall Length (mm)	5,430
Overall Height – Roof Up (mm)	3,176
Overall Height – Roof Down (mm)	2,220
Overall Body Width (mm)	2,210
Tare Weight (kg)	1,780*
ATM Weight (kg)	2,180*

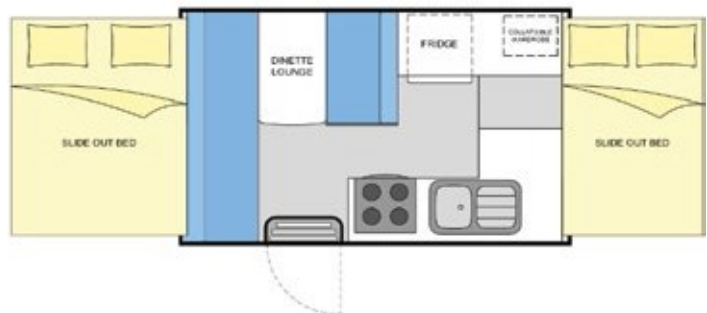

Silhouette S401X4

Body Length (mm)	3,400
Overall Length (mm)	5,430
Overall Height – Roof Up (mm)	3,176
Overall Height – Roof Down (mm)	2,220
Overall Body Width (mm)	2,210
Tare Weight (kg)	1,860*
ATM Weight (kg)	2,260*

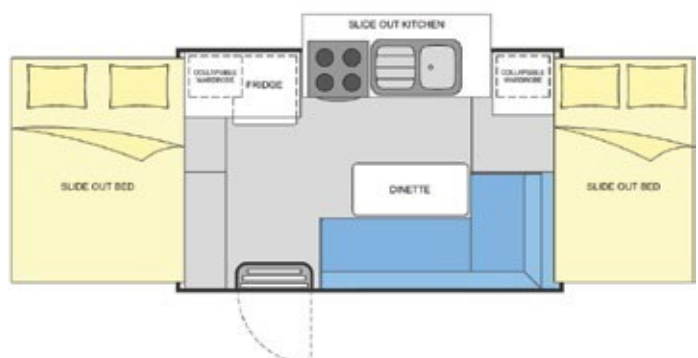

*Note: Tare and ATM weights will vary when adding optional extras.



Silhouette S421X4

Body Length (mm)	3,600
Overall Length (mm)	5,630
Overall Height – Roof Up (mm)	3,176
Overall Height – Roof Down (mm)	2,220
Overall Body Width (mm)	2,210
Tare Weight (kg)	1,870*
ATM Weight (kg)	2,270*

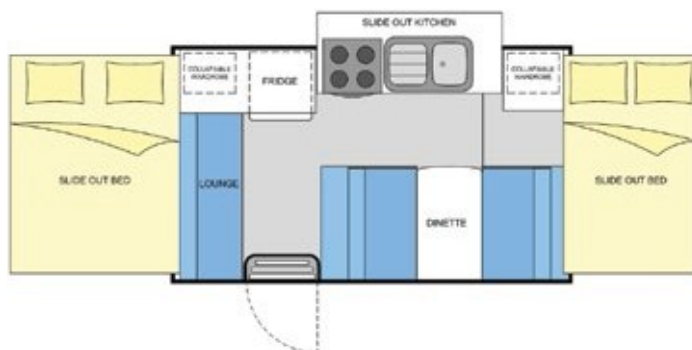

Silhouette S450X4

Body Length (mm)	3,900
Overall Length (mm)	5,920
Overall Height – Roof Up (mm)	3,176
Overall Height – Roof Down (mm)	2,220
Overall Body Width (mm)	2,210
Tare Weight (kg)	1,930*
ATM Weight (kg)	2,330*

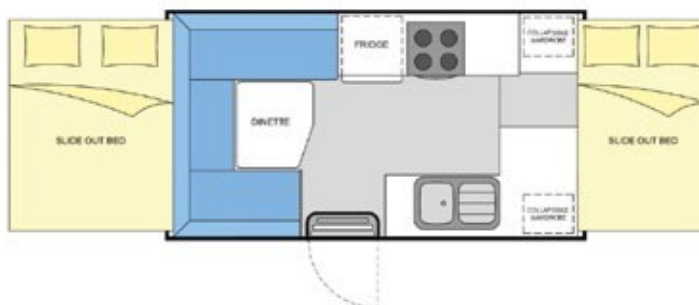

*Note: Tare and ATM weights will vary when adding optional extras.