

Windsor

SEKA

SK/SKL521 | SK/SKL552s | SK554

SK/SKL567s | SK569 | SK611s





The Windsor Seka is a range of pop top caravan built with freedom and simplicity in mind. The lowline models are designed for storage in garages and carports when not in use - sitting under 2.2 metres when stored but raising to full caravan height when extended.

Built with pride in Western Australia, the Windsor Seka's low tow height is great for storage at home and allows for greater fuel efficiency when on the move.

All Sekas are built on a solid welded chassis and coated with a corrosion resistant gal. It comes with 15 inch alloy wheels and quick-release jack legs. The A-frame holds two 9kg gas bottles and an outside mains water tap.

The Esy-Tow™ Tourer suspension provides a predictable and easy towing system, eliminating sideways and axle suspension movement for positive tracking.

The kitchen is packed with standard features such as a 90L 3-way fridge, microwave, stove with grill and 12V recessed rangehood.

The stainless steel bowl with drainer includes a standard kitchen mixer tap.

With standard built-in modern cabinetry for maximum storage space, the Seka includes a laminated benchtop with flush gloss cabinets and drawers.

LED lighting is also provided throughout the van, providing a modern touch.

The canvas windows in the pop top roof allows for additional, natural airflow, with built-in fly screens to keep out the bugs.

All models come with an easy-lift bed with under storage, a memory foam mattress, block-out blinds and air conditioning for maximum comfort. The Windsor Seka is also available in models that include ensuite facilities.

Other features include a retractable awning, annex light and external power outlet. The Seka also includes a built-in sound system with radio, CD, DVD and USB connectivity providing sound through internal and external speakers. Also included is a pre-wired reverse camera provision.

The water gauge allows you to check the water tank levels before setting off, very useful when you need to carry drinking water on your trip.

Standard safety features include a smoke detector, fire extinguisher and non-slip entry step on all models. ■



SEKA FLOOR PLANS



Seka SK521

Body Length (mm)	5,240
Overall Length (mm)	7,050
Overall Height – Roof Up (mm)	2,840
Overall Height – Roof Down (mm)	2,400
Overall Body Width (mm)	2,540
Tare Weight (kg)	1,550*
ATM Weight (kg)	1,850*

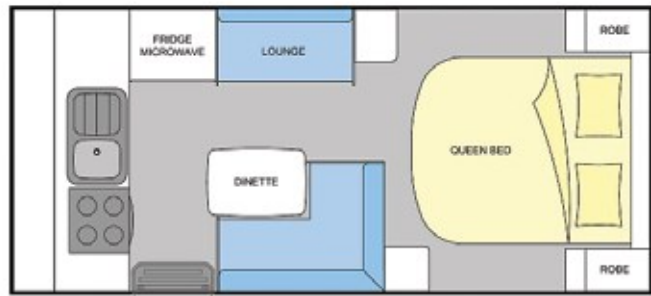

Alternative layout option: 2 x single beds

Seka SK552s

Body Length (mm)	5,545
Overall Length (mm)	7,355
Overall Height – Roof Up (mm)	2,840
Overall Height – Roof Down (mm)	2,400
Overall Body Width (mm)	2,540
Tare Weight (kg)	1,630*
ATM Weight (kg)	1,930*

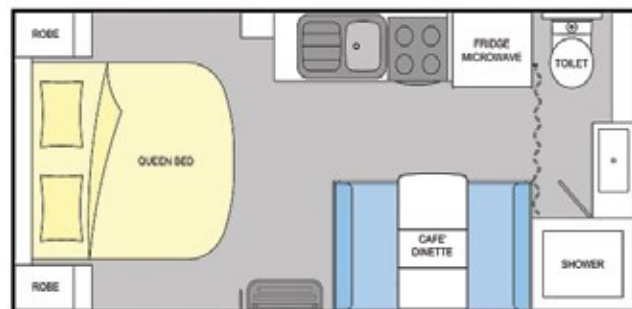

Alternative layout option: 2 x single beds and/or L shape dinette

Seka SK554

Body Length (mm)	5,545
Overall Length (mm)	7,355
Overall Height – Roof Up (mm)	2,840
Overall Height – Roof Down (mm)	2,400
Overall Body Width (mm)	2,540
Tare Weight (kg)	1,560*
ATM Weight (kg)	1,860*

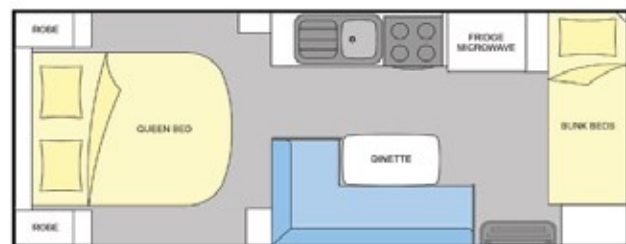

Alternative layout option: 2 x single beds

*Note: Tare and ATM weights will vary when adding optional extras. Images are not to scale and are only for illustration purposes.

SEKA FLOOR PLANS

Seka SK567s

Body Length (mm)	5,670
Overall Length (mm)	7,455
Overall Height – Roof Up (mm)	2,840
Overall Height – Roof Down (mm)	2,400
Overall Body Width (mm)	2,540
Tare Weight (kg)	1,830*
ATM Weight (kg)	2,230*

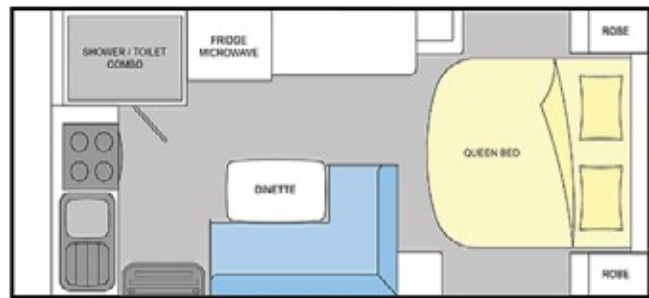

Alternative layout option: 2 x single beds

Seka SK569

Body Length (mm)	5,670
Overall Length (mm)	7,455
Overall Height – Roof Up (mm)	2,840
Overall Height – Roof Down (mm)	2,400
Overall Body Width (mm)	2,540
Tare Weight (kg)	1,740*
ATM Weight (kg)	2,140*

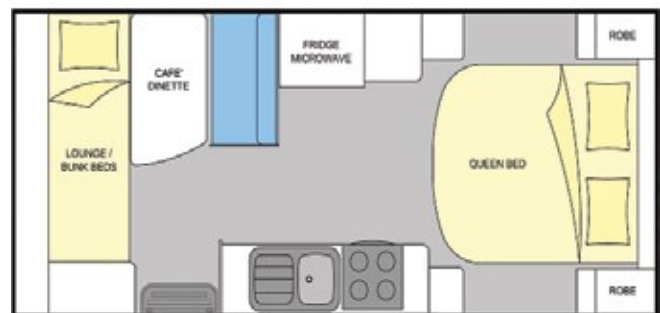

Alternative layout option: 2 x single beds

Seka SK611s

Body Length (mm)	6,170
Overall Length (mm)	7,950
Overall Height – Roof Up (mm)	2,840
Overall Height – Roof Down (mm)	2,400
Overall Body Width (mm)	2,540
Tare Weight (kg)	1,900*
ATM Weight (kg)	2,300*



Alternative layout option: L shape dinette and/or 2 x single beds

*Note: Tare and ATM weights will vary when adding optional extras.

SEKA LOWLINE FLOOR PLANS



Seka SKL521

Body Length (mm)	5,240
Overall Length (mm)	7,000
Overall Height – Roof Up (mm)	2,710
Overall Height – Roof Down (mm)	2,125
Overall Body Width (mm)	2,540
Tare Weight (kg)	1,470*
ATM Weight (kg)	1,820*

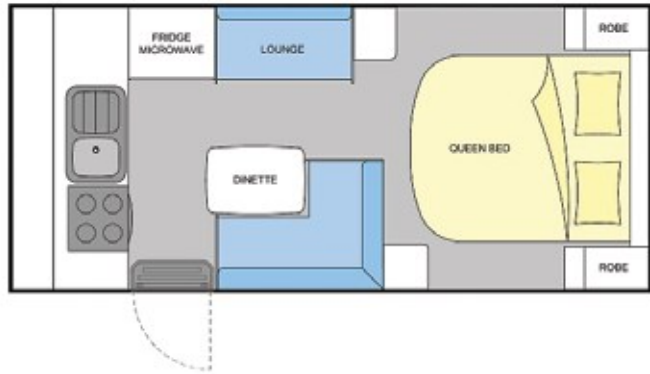

Alternative layout option: 2 x single beds

Seka SKL552s

Body Length (mm)	5,545
Overall Length (mm)	7,355
Overall Height – Roof Up (mm)	2,710
Overall Height – Roof Down (mm)	2,125
Overall Body Width (mm)	2,540
Tare Weight (kg)	1,610*
ATM Weight (kg)	1,910*

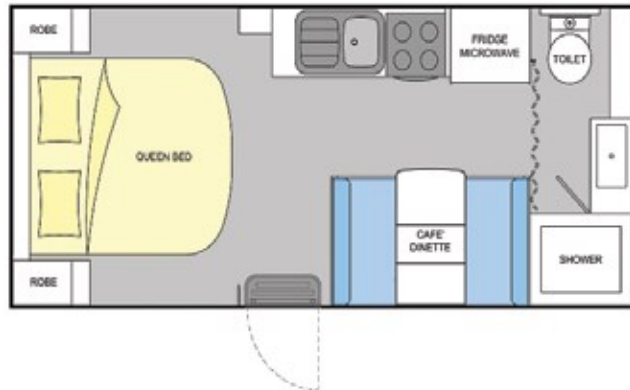

Alternative layout option: L shape dinette and/or 2 x single beds

Seka SKL567s

Body Length (mm)	5,670
Overall Length (mm)	7,455
Overall Height – Roof Up (mm)	2,710
Overall Height – Roof Down (mm)	2,125
Overall Body Width (mm)	2,540
Tare Weight (kg)	1,720*
ATM Weight (kg)	2,120*



Alternative layout option: 2 x single beds

*Note: Tare and ATM weights will vary when adding optional extras. Images are not to scale and are only for illustration purposes.